

HP Latex 730 Printer series

Printer assembly instructions

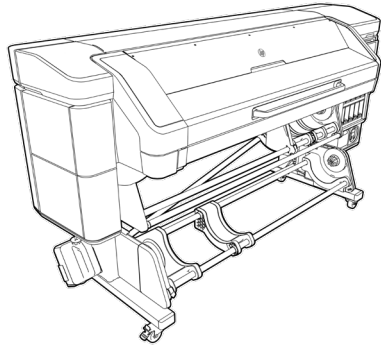

5 people are required to perform certain tasks.



Time required for assembly of the printer is approximately 210 minutes.

Note: Depending on your LAN installation, a web proxy server name and port may be required to complete the installation of this printer. Contact your IT manager to get connectivity settings.

Edition 1

© Copyright 2025 HP Development Company
L.P. Large Format Division
Camí de Can Gualles 1-21
08174 - Sant Cugat del Vallès
Barcelona - Spain

All rights reserved



Please read these instructions carefully. These assembly instructions explain how to assemble the printer. Because spare screws are supplied, some screws will remain unused after assembly of the printer.

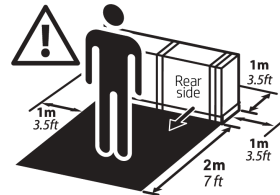

The space required for assembly is:
1 m (3.5 ft) at the front, 2 m (7 ft) at the rear, and 1 m (3.5 ft) at the sides.

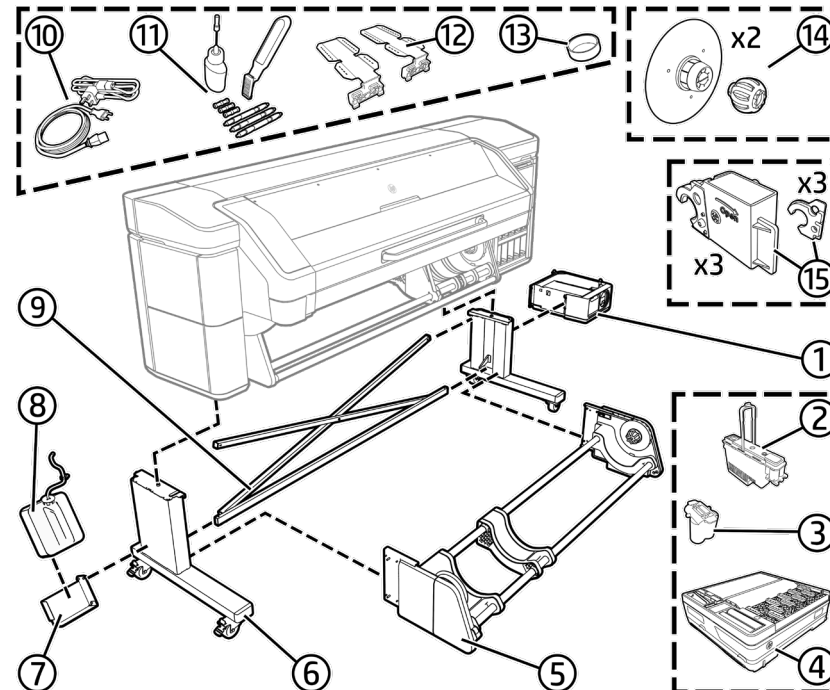

Box Contents

1. White ink kit (only for HP Latex 730W)
2. Printheads
3. Purgers
4. Maintenance cartridge and Ink collector Unit
5. Take-up reel
6. Stand legs
7. Condensation collector support
8. Condensation collector
9. Crossbar and sway bar
10. EE cables
11. User maintenance
12. Edge holders
13. Condensation collector cap
14. 2-inch hub
15. Lubrication Felts Kit

Not included

LAN cable, roll of substrate, and ink cartridges

Tools required:

Electrical nut driver size 17 / Cutter / Forklift / Flat screwdriver

Note: Assembly can be done with manual tools only, but installation will take longer.

Note: The printer body cannot be disassembled from the legs. Correct printer functionality cannot be assured.

Remove the packaging

1

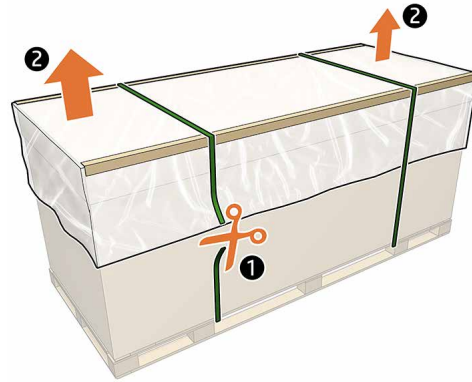

Remove the protective plastic sheet, carefully cut the box straps and then remove the corner posts.

2



Lift up the box and remove it.

3

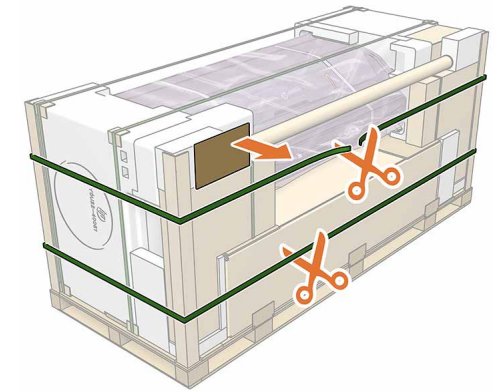

Cut the 2 horizontal straps.
Important: Make sure that nothing falls from the pallet.

4

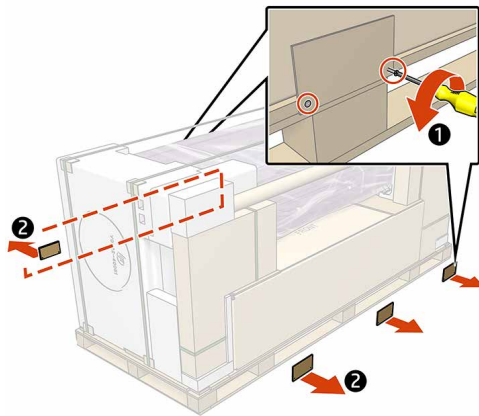

Remove the wooden stops from the front and back of the printer.

5

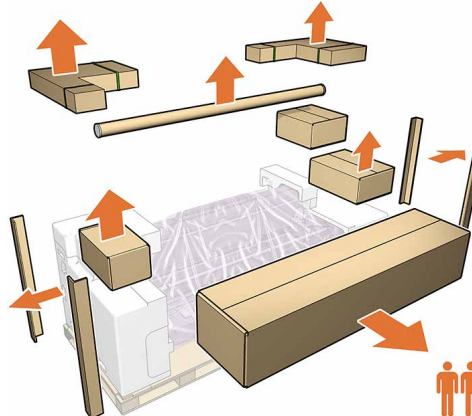

Remove all the boxes.
Note: Remove the 3 white caps.
Note: Box positions may change depending on the model.
Important: Save them because you will need them later.

Rotate the printer

6

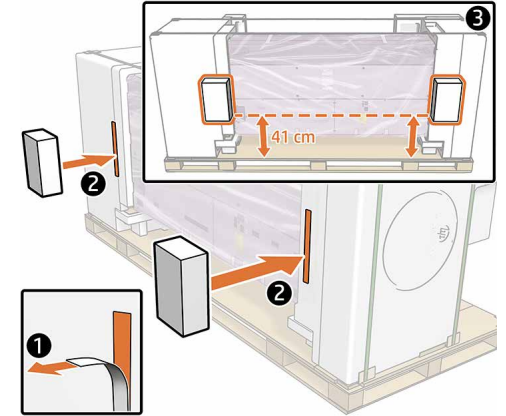

Remove the protection tape, and fix the white caps onto the printer.
Important: Fix 1 cap on one side and 2 on the other side. Approximate height for each side: 41 cm from pallet

7

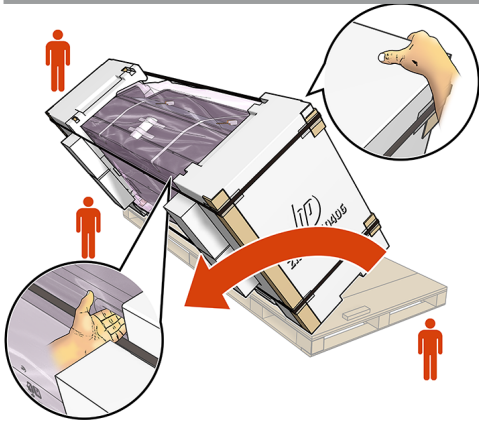

Rotate the printer onto its back.
Important: 3 people are needed.

8

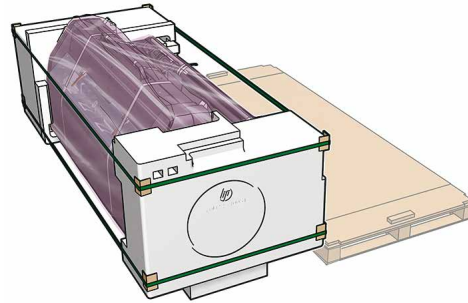

Lay the printer on the ground.

9

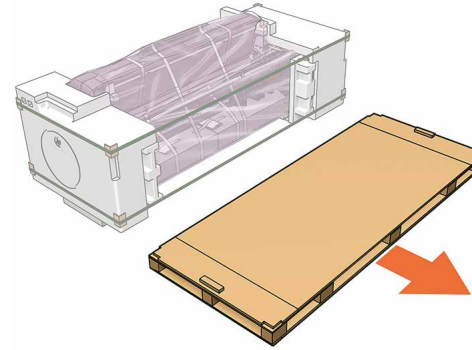

Remove the pallet.

10

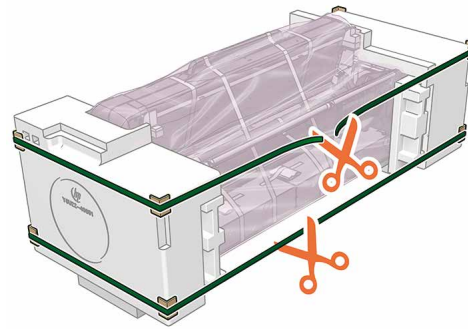

Cut the straps.

11

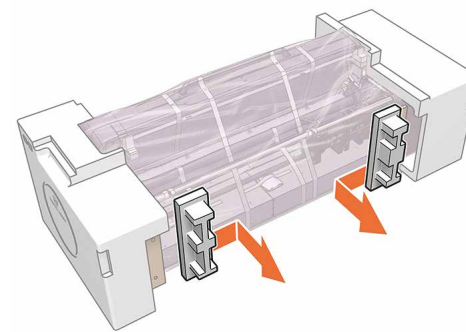

Remove the 2 white caps.

12

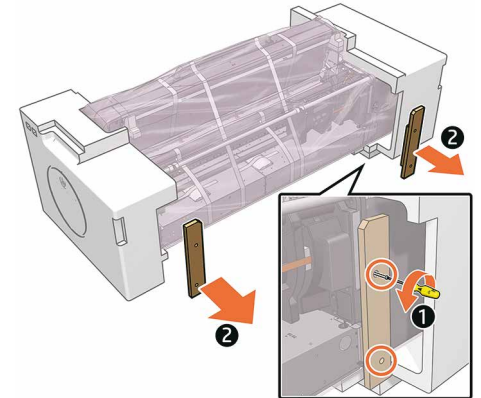

Remove the 2 wooden caps (2xT25 screws each).

Assemble the stand

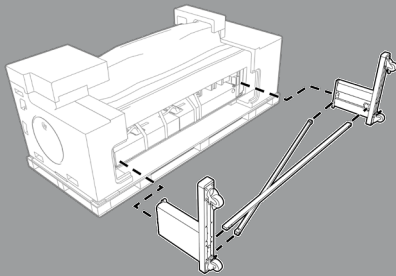

Ensure all stand screws are tightened to the recommended torque of 25lbf-in (2.8Nm).

13

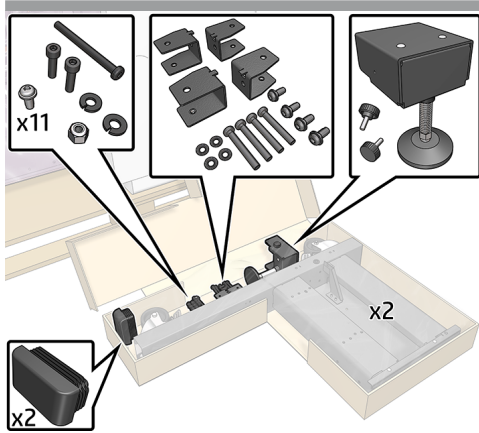

Take the Hardware Kit with Part Number left (L) YOU21-60486 that includes the necessary clamps and screw to assembly the legs and crossbars. The screw kit is included in the Right leg packaging (YOU21-60485).

14

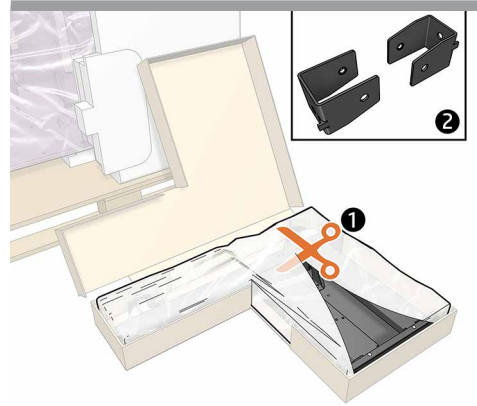

Remove the plastic bags from both legs.

15

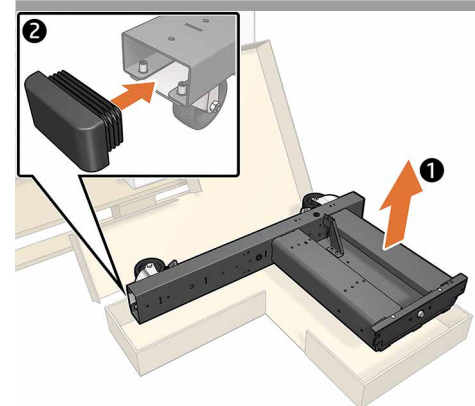

Remove the 2 sway bar holders and install foot endcaps.

16

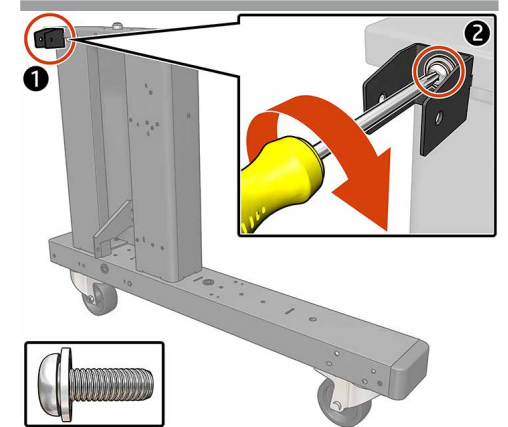

Position the sway bar holder at the top of the right leg (1) and fix it into place with a gray T25 screw from the transparent bag (2).

17

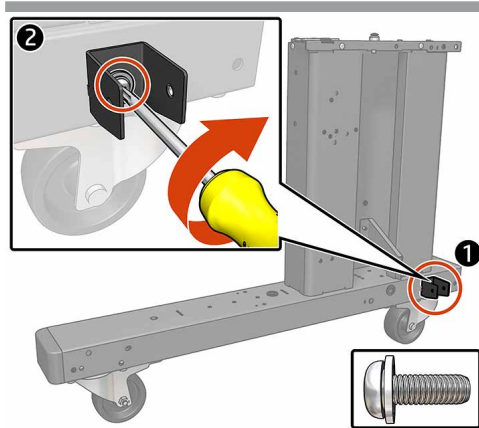

Position the sway bar holder at the bottom of the left leg (1) and fix it into place with a gray T25 screw from the transparent bag (2).

18

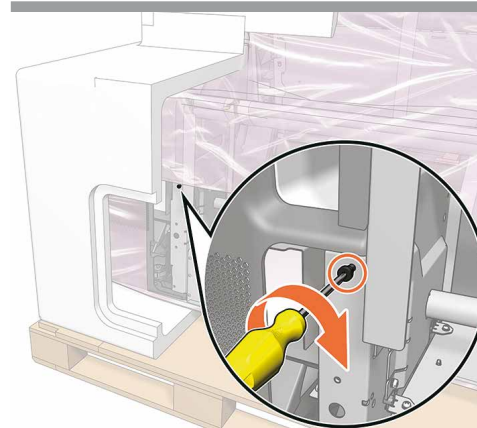

Install the shoulder screw for the left leg.

19

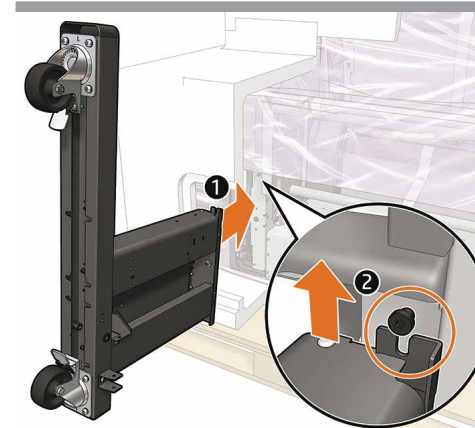

Install the left leg under the shoulder screw.

20

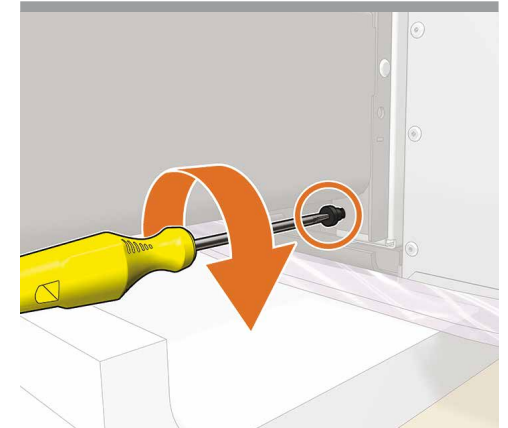

Fix the bottom of the left leg with a shoulder screw.

21

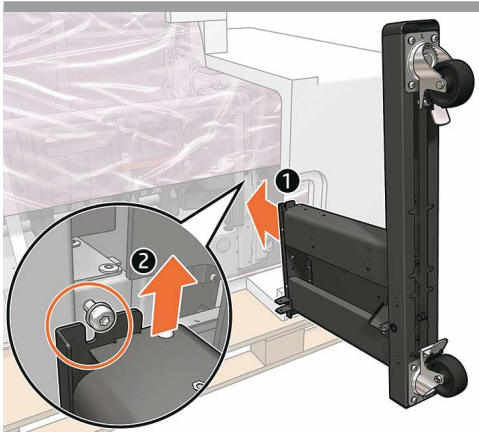

On the right side install a normal screw, and install the right leg.

Note: Do not fully tighten the screw yet.

22

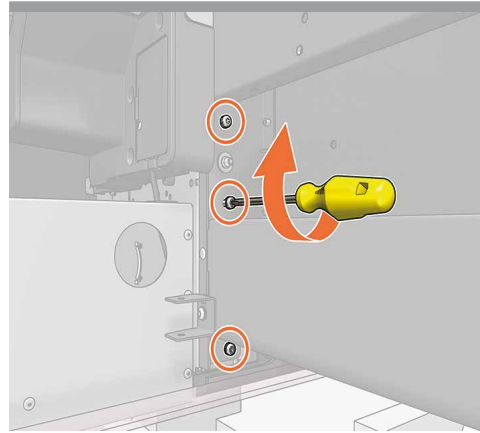

Fix the right leg with 3 more screws (4 screws in total).

Note: Screws are on Hardware Kit with Part Number left (L) YOU21-60486

23



Take the 3 crossbars and screws from the box.

24

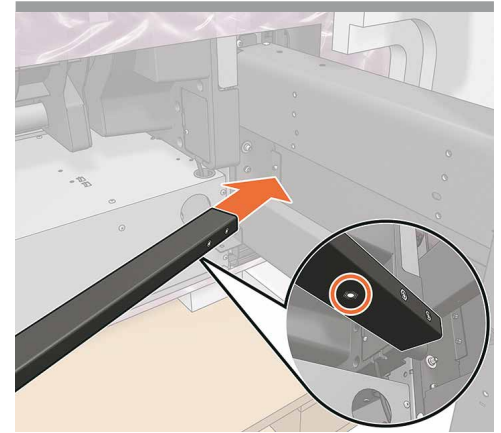

Take the longest crossbar and place it into the right leg slot.

25

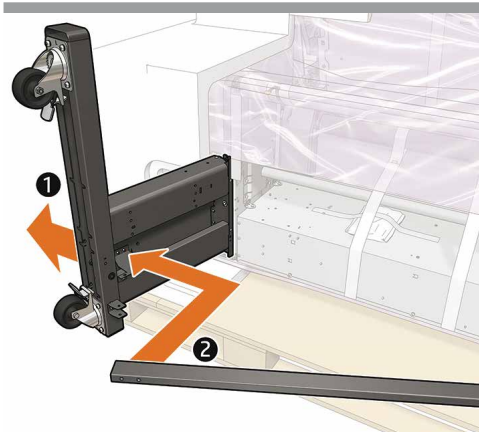

Move the left leg out and place the other end of the crossbar into the left leg slot.

26

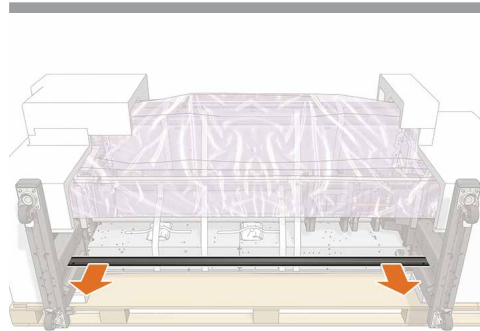

Move the crossbar to the bottom of both legs.

27

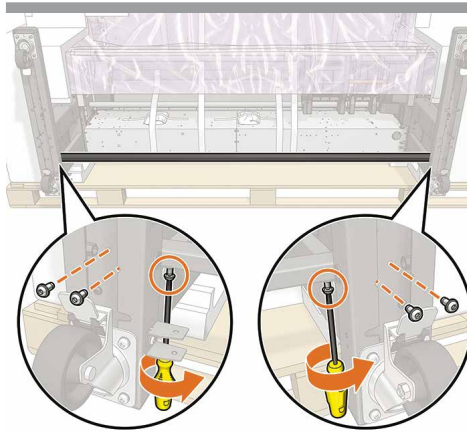

Fix the crossbar to both legs with 3 screws each side.

Important: Do not over tighten the screws

28

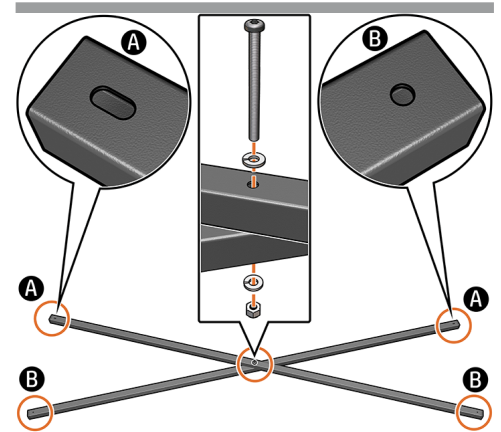

Fix the two crosspads.

29

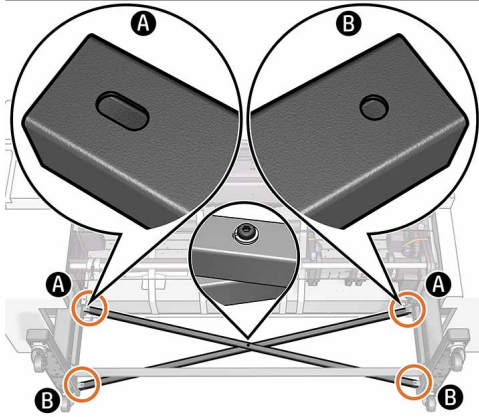

Install the sway bars.

Important: The head of the center screw must face upwards.

30

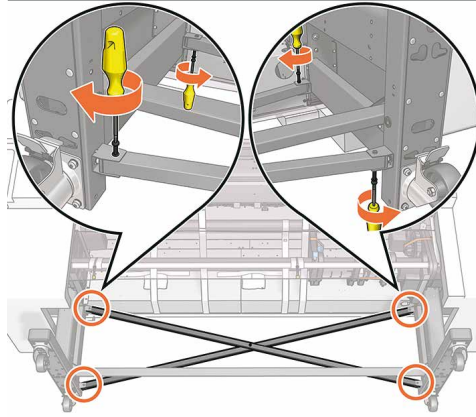

Start with the right leg and fix both sway bars with 2 black screws each.

31

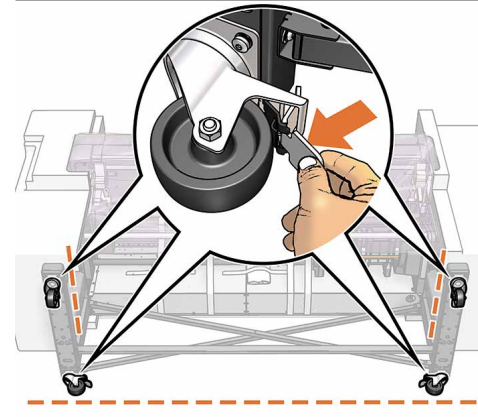

Place the stand wheels in the position shown.

Important: Make sure that all the brakes are ON.

Important: It is CRITICAL to assemble the cross bars before rotating the printer. Failure to do so will result in deformation of the lower chassis and the printer will be damaged beyond repair.

32

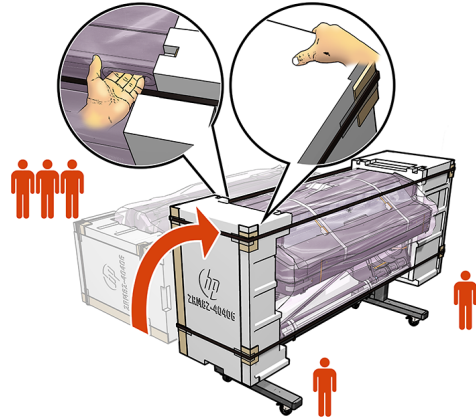

Carefully lift the printer upright.

Important: 3 people are needed at the back of the printer and 2 at the front.

33

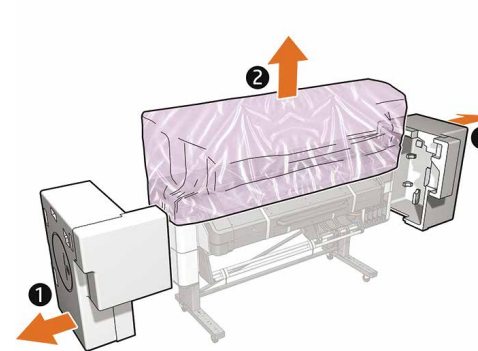

Remove the 2 foam end caps, and remove the plastic covering from the printer.

34



Remove all the orange tapes.

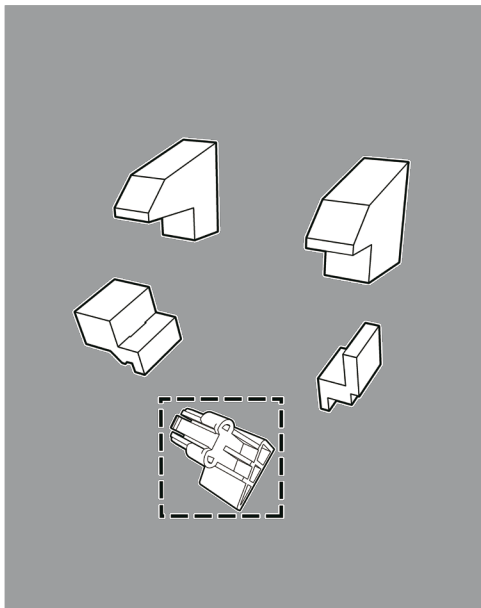

35



Raise the curing module.

36

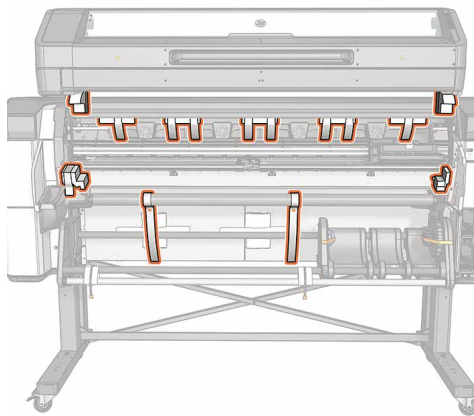

Remove all the tapes.

37

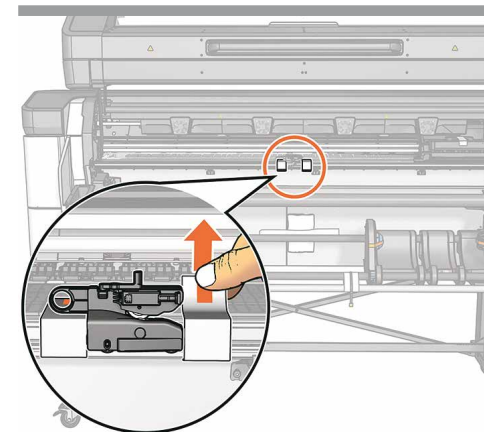

Remove the tape from the cutter.

Caution: Be careful when removing the tape from the cutter, it stuck to the platen and also to the plastic part of the cutter guide. Do not remove the plastic guide when peeling the tape off the platen.

38



Open the carriage cover.

39

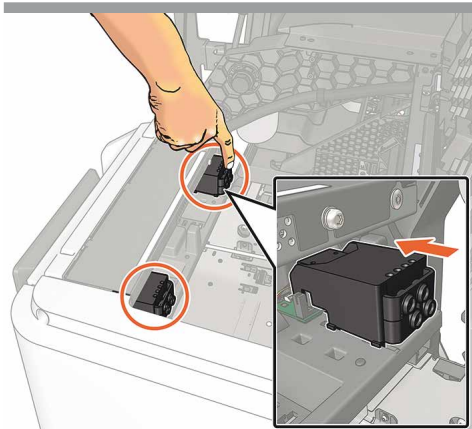

Check that the primer modules are firmly in place.

40

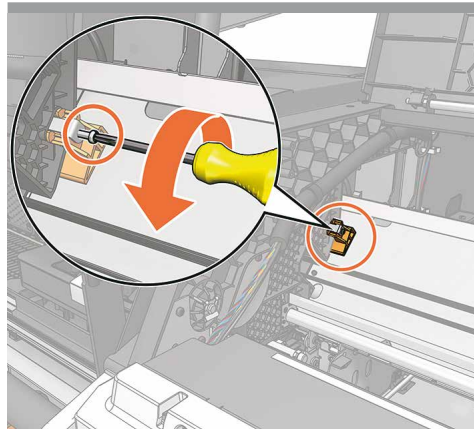

Remove the screw from the orange pin

41

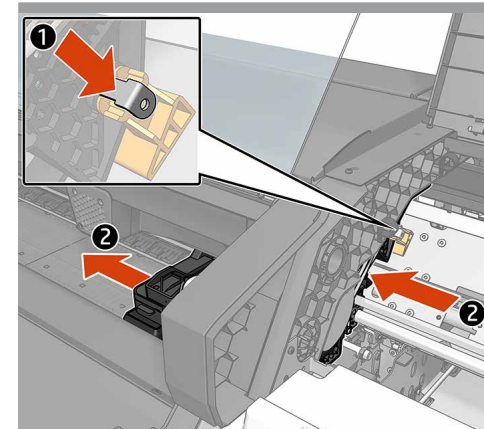

Remove the metal pin (1), then slide the carriage to the left (2).

42

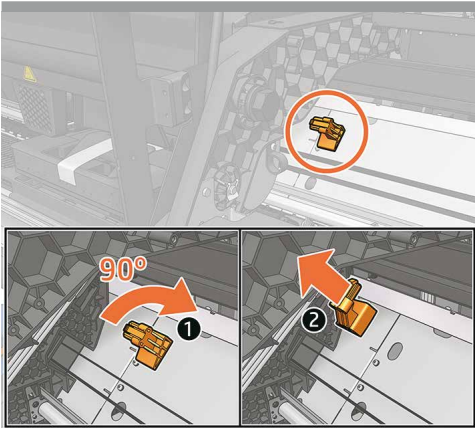

Rotate the orange piece clockwise and take it out.
Important: Keep it for future transport

43

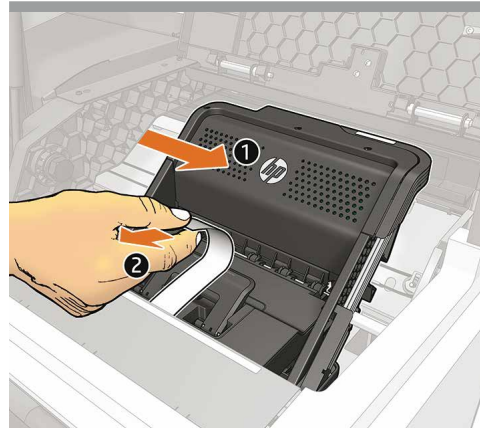

Slide the carriage to the right and remove the strap.

44



Close the carriage cover.

45



Lower the curing module.

46

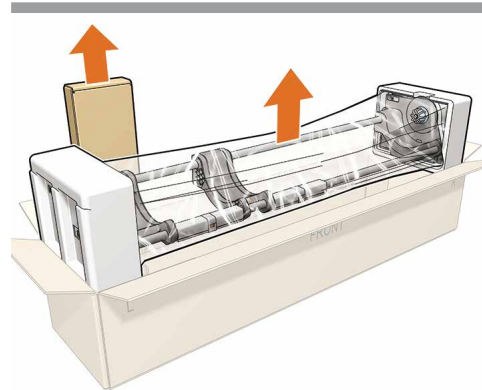

Open the box and remove the take-up reel. Remove take up reel support from the box.

47

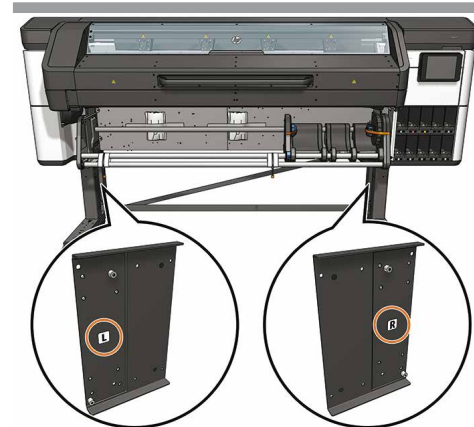

Place the take-up reel supports as labeled (left/left, right/right).

48

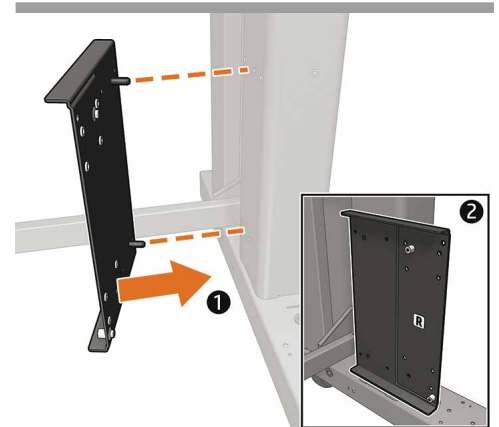

Put the take-up reel support into place.

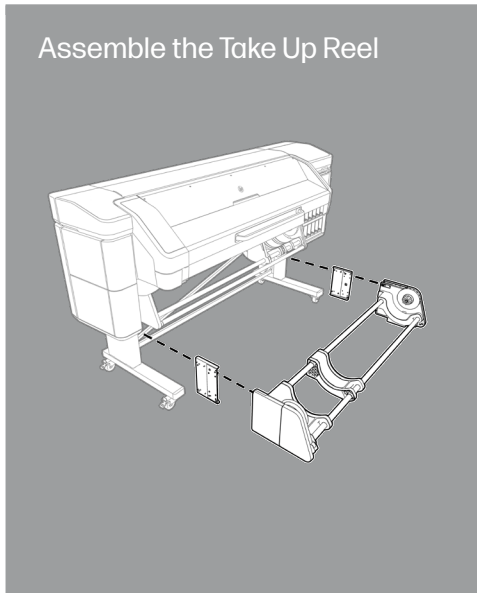

Assemble the Take Up Reel

49

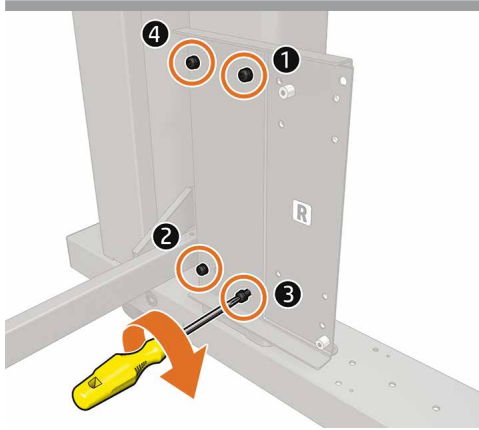

Fix it with 4 screws included in the box in the order indicated above,
Note: Repeat the same process with the left take-up reel support.

50

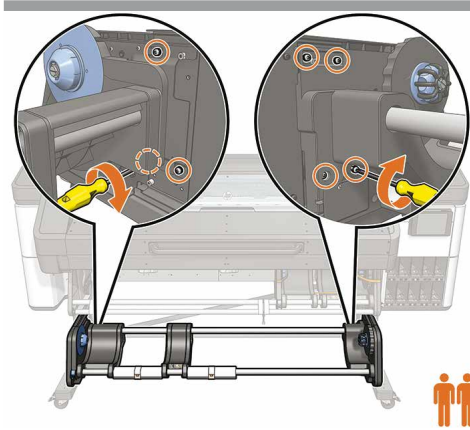

Place the take-up reel onto the holders and fix it into place with 4 screws on the right and 3 on the left.
Important: A minimum of two people is required.

51

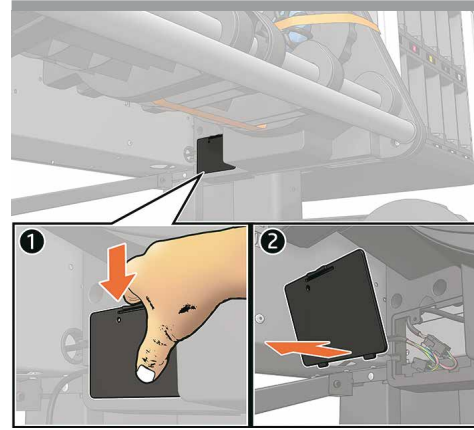

Remove the cover from below the right leg.

52

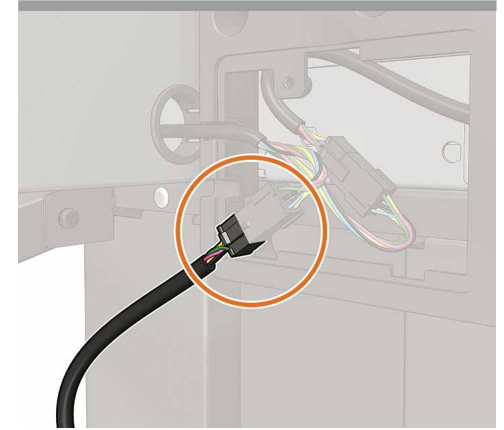

Connect the take-up reel to the corresponding connector.

53



Put the cables back in.

54

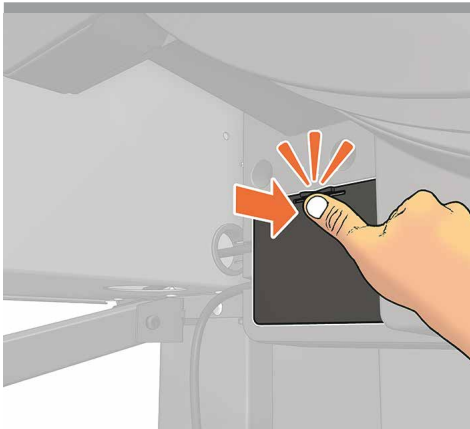

Close the cover.

55

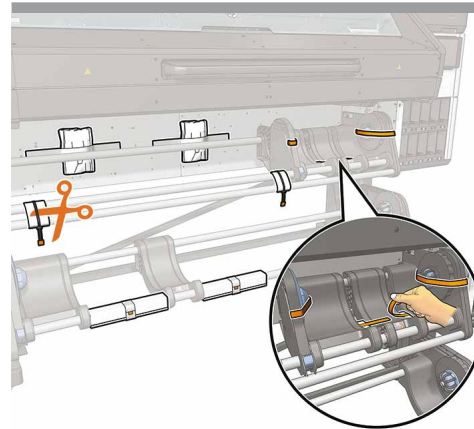

Remove all the packaging.

Condensation collector

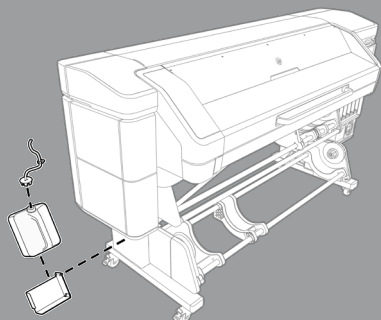

56

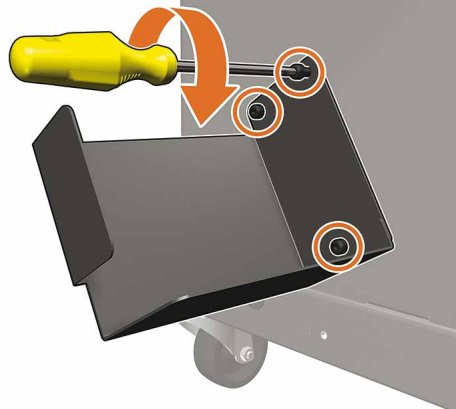

Take the water bottle holder from the box and fix it to the bottom of the left leg with 3 screws.

57

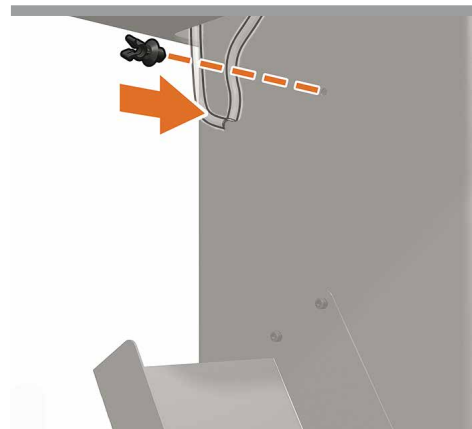

Place the tube holder on top of the bottle holder.

58

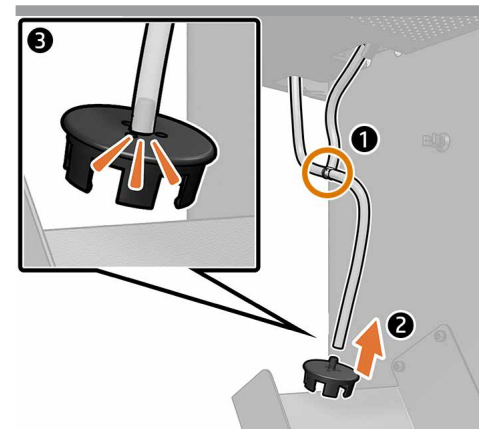

Identify the two hanging tubes and insert a T-connector between them. Then, connect a third tube to the remaining port of the T-connector, and attach the condensation collector cap to this tube.

59

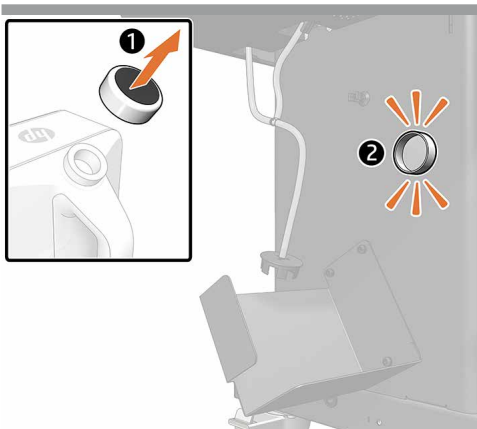

Keep the cap and place it onto the leg (it is magnetic).

60

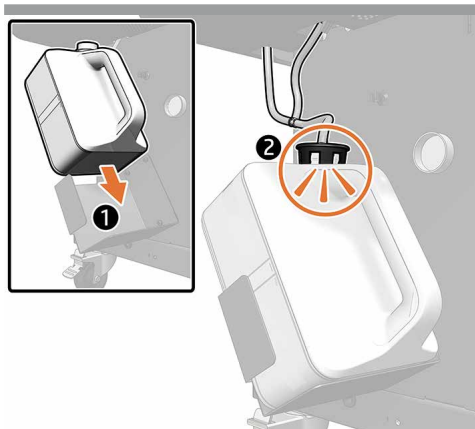

Insert the condensation collector into the holder and connect the tube. Do not tighten the tubes in the tube holder as they should remain loose.

White ink module (HP Latex 730W Printer only)

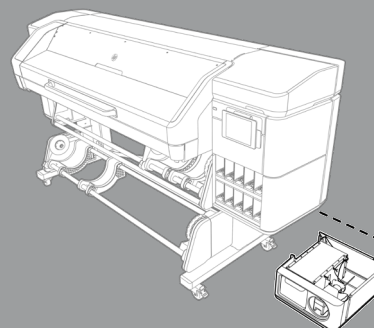

61

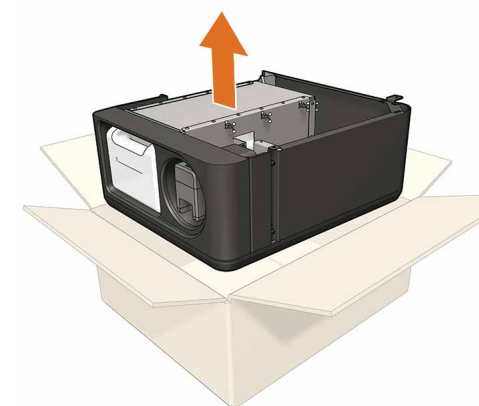

Take the white module to be installed on the right-hand side of the printer.

62

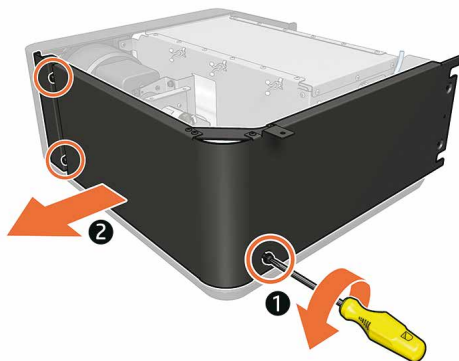

Remove the 3 screws and the lateral cover from the module.

63

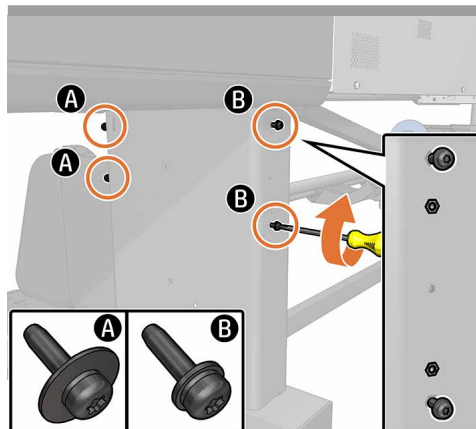

Insert 2 screws at the rear in the highest and lowest holes. Insert 2 screws with large washers at the front. **Important:** Do not tighten the screws yet.

64

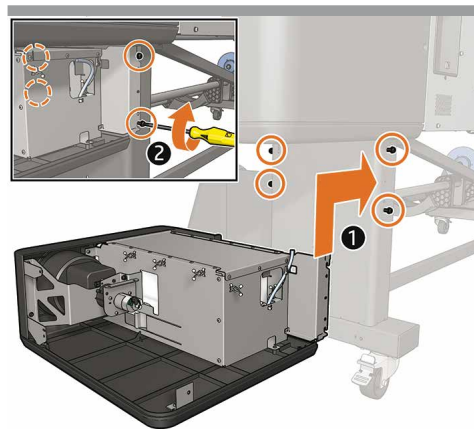

Place the module underneath the front panel. Tighten the 4 screws.

65

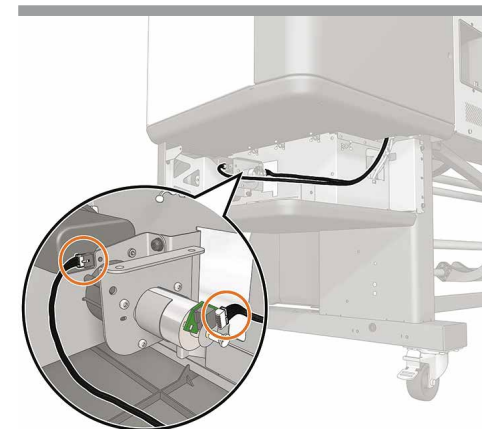

Connect the wheel and presence cable to the white module entry point.

66

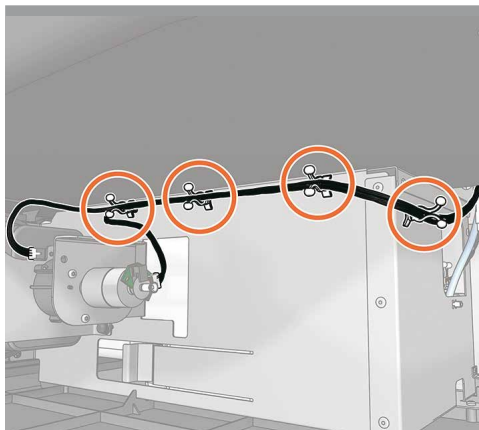

Place the cable into the white colored top pins. Rotate the pins to fix the cable properly.

67

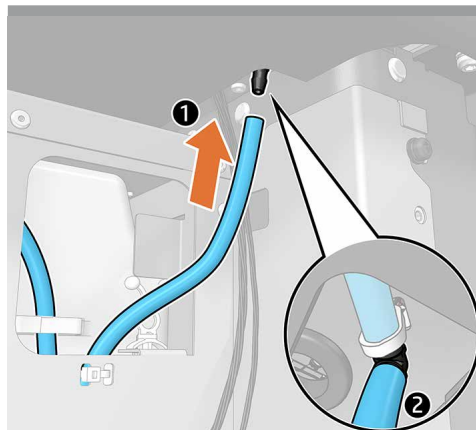

Connect the blue water tube.

68

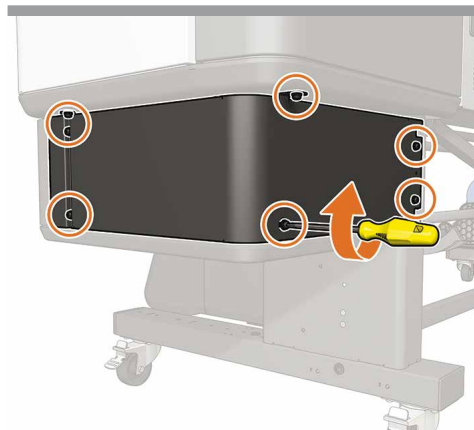

Put the lateral cover back onto the module and fix with the 3 screws removed earlier.

69

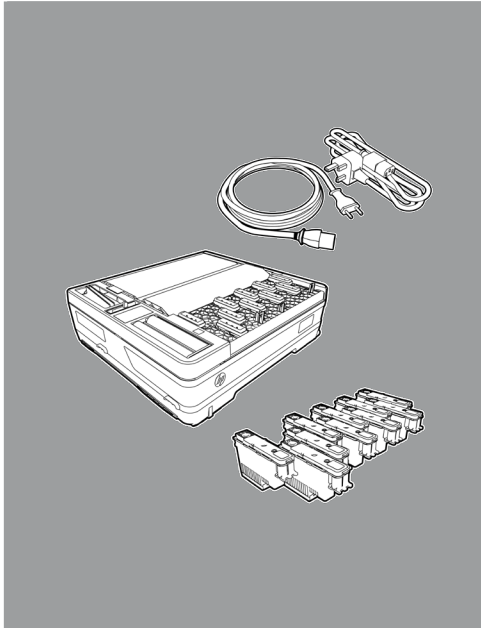

70

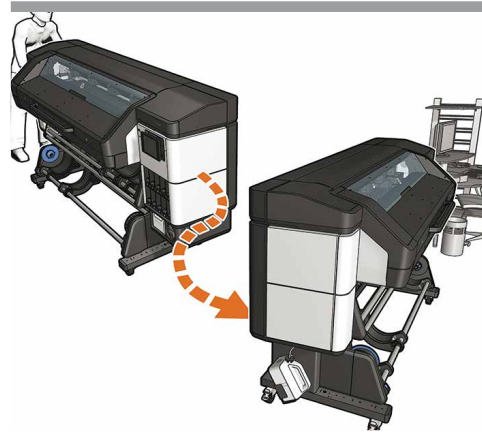

Move the printer to its final location.

71

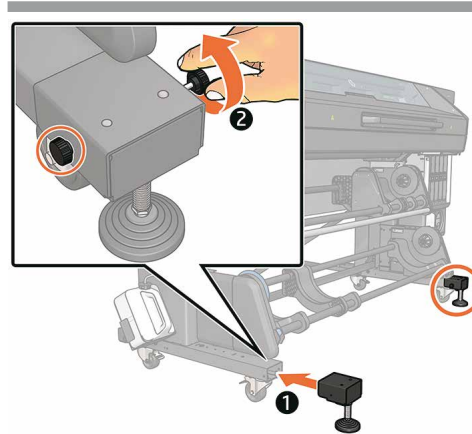

Install the 2 extension feet onto the front of the legs and fix with 2 screws each foot.

72

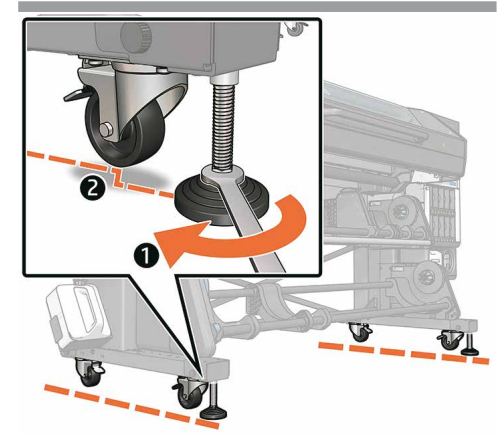

Ensure that the printer is standing on the front feet and not on the front wheels.

Note: The wheels should just touch the ground.

73



Connect LAN and power cord cables: printer and curing.

Important: Ensure that the building's electrical system meets the printer's electrical requirements. Please refer to the Site Preparation Guide for more information.

74

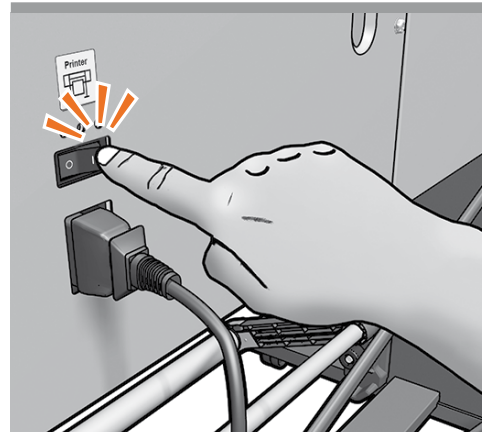

Switch on the printer at the back.

75



Now follow the start up instructions displayed in the front panel.

76



The installer is fully responsible of installing the RIP software and train the customer about how to operate with the printer, find and install new media profiles, how to print from the RIP SW. Use the Quick Guide for training topics, and leave it installed on the computer for future reference. The installer needs to send the End of Installation Report to register the printer, and confirm printer's warranty.



If the network requires a web proxy to access the Internet, ensure you have the proxy port and proxy address information.

If you setup a Manual IP Address, make sure to correctly enter the DNS and Gateway addresses. This information can be retrieved from a computer on the local network with internet connectivity, and should have been obtained during site preparation. See the Site Preparation Guide for instructions on how to obtain web proxy configuration information.



Important: Use the HP PrintOs Service Center Mobile Application to complete the End of Installation and register the printer in the PrintOS.

After the report is submitted, a confirmation message will be sent to you with the warranty validation information.